

REASSEMBLY

HINT:

Use high-temperature grease to lubricate the bearings and gears when assembling the starter.

1. PLACE ARMATURE INTO FIELD FRAME

- (a) Apply grease to the armature bearings.
- (b) Insert in armature into the field frame.

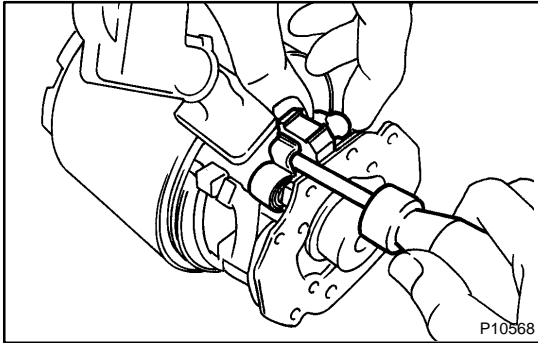

2. INSTALL BRUSH HOLDER

- (a) Place the brush holder on the field frame.
- (b) Using a screwdriver, hold the brush spring back, and connect the brush into the brush holder. Connect the 4 brushes.

NOTICE:

Check that the positive (+) lead wires are not grounded.

- (c) Install a new O-ring to the groove of the field frame.
- (d) Install the end cover to the field frame with the 2 screws.
Torque: 3.8 N·m (39 kgf·cm, 34 in.-lbf)

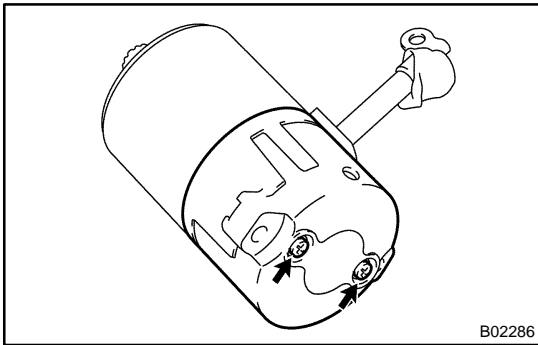

3. INSERT STEEL BALL INTO CLUTCH SHAFT HOLE

- (a) Apply grease to the steel ball.
- (b) Insert the steel ball into the clutch shaft hole.

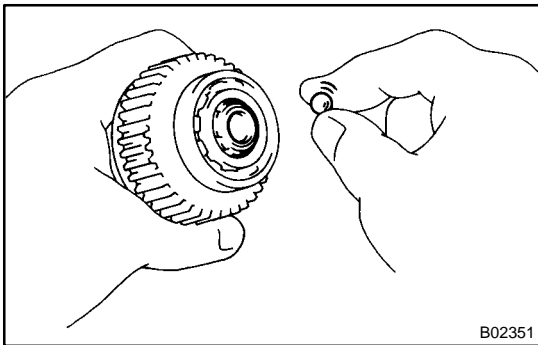

4. INSTALL STARTER HOUSING, CLUTCH ASSEMBLY AND GEARS

- (a) Apply grease to the return spring.
- (b) Insert the return spring into the magnetic switch hole.

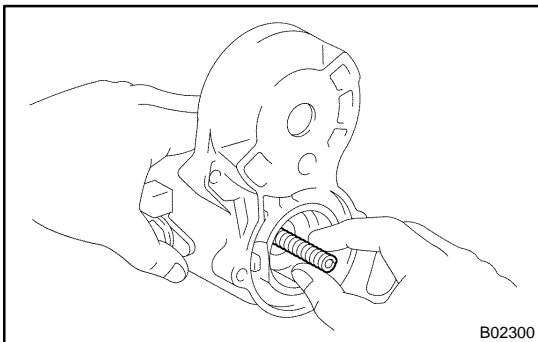

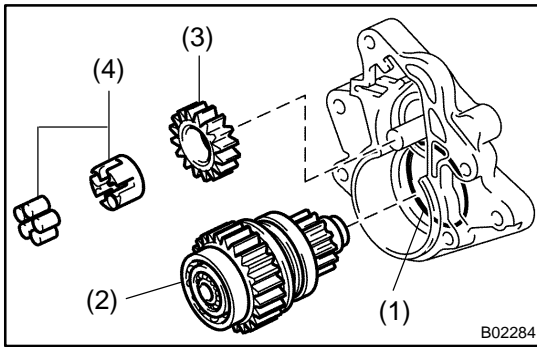

(c) Place these parts on the starter housing:

- (1) Place the new O-ring.
- (2) Place the starter clutch assembly.
- (3) Place the idler gear.
- (4) Place the bearing.

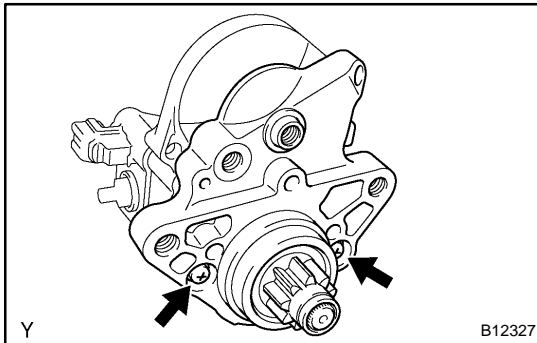

(d) Install the starter housing to the magnetic switch with the 2 screws.

Torque: 9.3 N·m (95 kgf·cm, 82 in.-lbf)

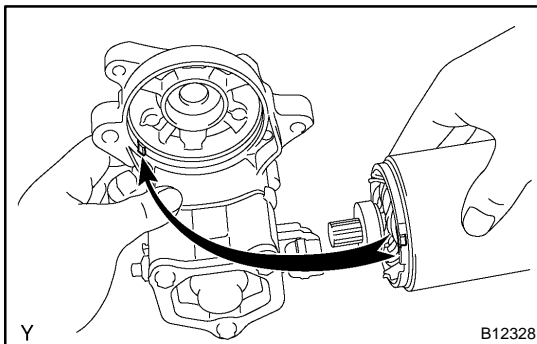

5. INSTALL FIELD FRAME AND ARMATURE ASSEMBLY

- (a) Install a new O-ring to the groove of the field frame.
- (b) Align the protrusion of the field frame with the groove of the magnetic switch, and install the field frame and armature shaft assembly.

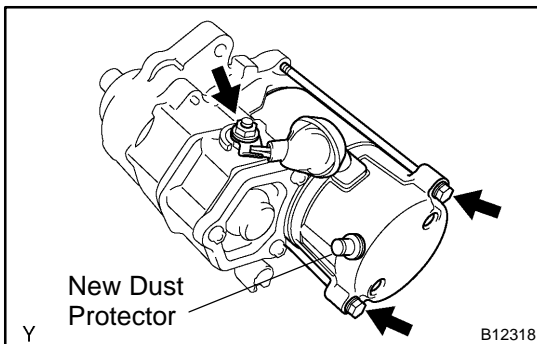

(c) Install the field frame and armature assembly with the 2 through bolts.

Torque: 9.3 N·m (95 kgf·cm, 82 in.-lbf)

(d) Connect the lead wire to terminal C with the nut.

Torque: 5.9 N·m (60 kgf·cm, 52 in.-lbf)